

DTC	C1786/86	HEIGHT CONTROL SWITCH CIRCUIT
-----	----------	-------------------------------

CIRCUIT DESCRIPTION

Vehicle height can be chosen by pressing the height control switch.

By pressing "UP" side, vehicle height goes up.

By pressing "DOWN" side, vehicle height goes down.

DTC No.	DTC Detecting Condition	Trouble Area
C1786/86	Height control switch signal does not change.	<ul style="list-style-type: none"> • Height control switch • Height control switch circuit • Suspension control ECU

WIRING DIAGRAM

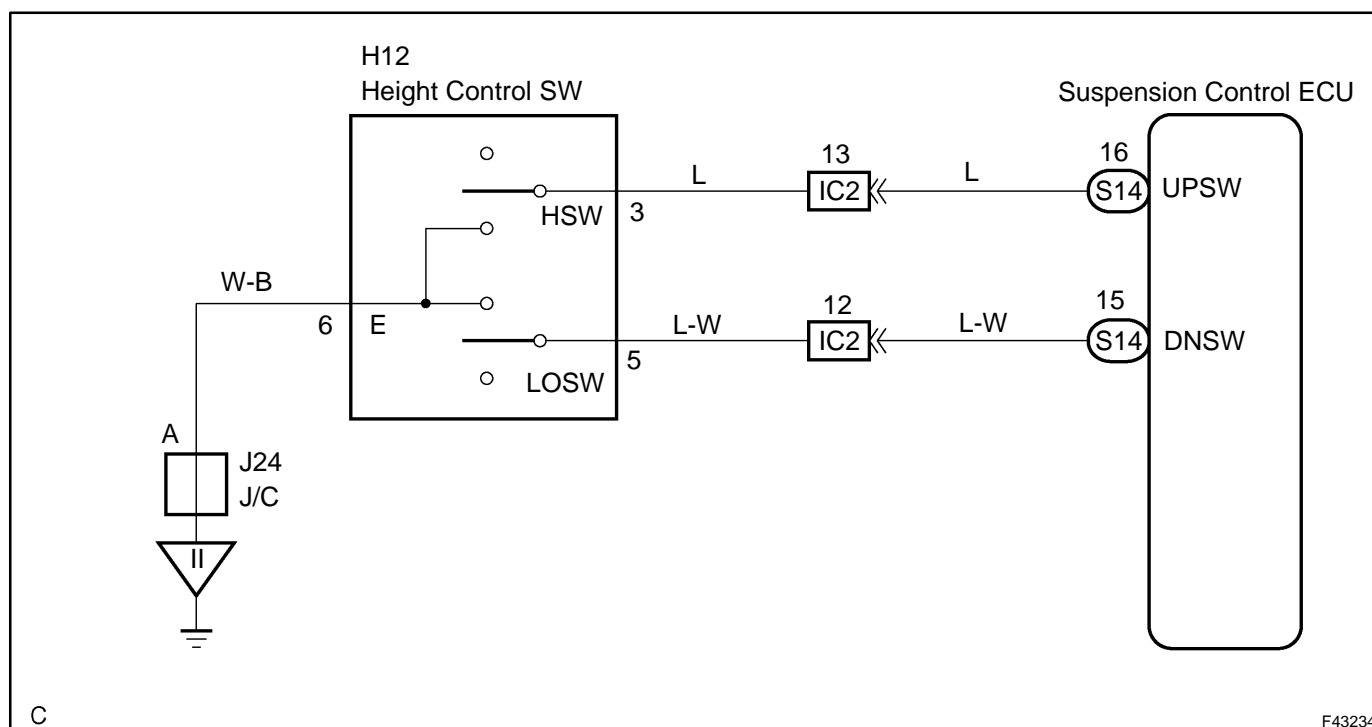

INSPECTION PROCEDURE

HINT:

Start the inspection from step 1 in case of using the hand-held tester and start from step 2 in case of not using the hand-held tester.

1 READ VALUE OF HAND-HELD TESTER

- (a) Connect the hand-held tester to the DLC3.
- (b) Turn the ignition switch ON, and turn the hand-held tester main switch ON.
- (c) Select the item "HEIGHT SW DOWN" or "HEIGHT SW UP" in the DATA LIST, and read its value displayed on the hand-held tester.
- (d) Check that the value displayed on the hand-held tester changes by pressing the height control switch "UP" and "DOWN".

Standard:

Height control switch value changes.

OK

CHECK AND REPLACE SUSPENSION CONTROL ECU (See page 01-35)

NG

2 INSPECT HEIGHT CONTROL SWITCH

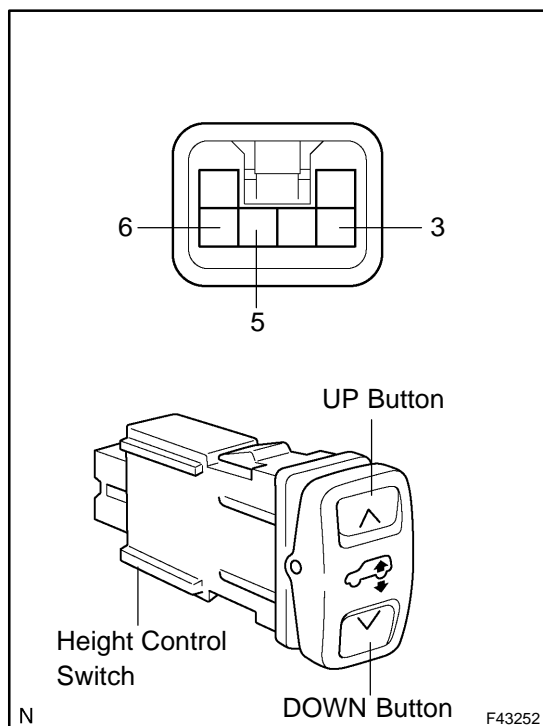

- (a) Remove the height control switch connector.
- (b) Check continuity between each terminal of the height control switch while pressing "UP" and "DOWN" button of the height control switch.

Standard:

Tester connection	Switch condition	Specification
"UP" button	3 - 6	Continuity
"DOWN" button		No continuity
"UP" button	5 - 6	No continuity
"DOWN" button		Continuity

NG

REPLACE HEIGHT CONTROL SWITCH

OK

3**CHECK HARNESS AND CONNECTOR(HEIGHT CONTROL SWITCH -
SUSPENSION CONTROL ECU)**

- (a) Check for open and short circuit in the harness and the connector between the height control switch and the suspension control ECU (See page [01-35](#)).

NG**REPAIR OR REPLACE HARNESS OR
CONNECTOR****OK****CHECK AND REPLACE SUSPENSION CONTROL ECU (See page [01-35](#))**